

NEW YORK CITY GREEN SCHOOLS GUIDE 2019 SCHEMATIC DESIGN PHASE OVERVIEW



GOAL OF PRESENTATION

- Learn how to complete the initial **project credit checklist** in order to set team compliance goals and targets
- Understand how to complete **credit narratives** to lay out the approach for pursuing each credit and compliance strategies
- Investigate how teams can **build off of** the **Pre-Schematic/IDP** phase submission in order to develop the Schematic Design submission
- Identify **supporting documentation** that needs to be included in the Schematic Design submission, including SCA specification sections and standard details that will need to be included in the construction documents to achieve compliance
- **AIA CES Course Information: 1.0 AIA LU**
Course #: GSG-SD
AIA Certificates will be distributed to all attendees.
Attendance for AIA Members will be reported.

SD TOOLS

GREEN SCHOOLS GUIDE WEBSITE

NYC Green Schools Guide

You are here: Design > NYC Green Schools Guide

Architecture & Engineering

Bulletins

Design Standards

Digital Video Surveillance Program

Downloads

Forms

General Policies

Historic Schools Rehabilitation Guide

Manuals: CADD, BIM, CIP

MS4 Pollution Prevention

NYC Green Schools Guide

Procedural Guidelines

Reference Materials

Scoping Guidelines

Submission for Payment

Universal Pre-K (UPK) and 3-K

Overview

GSG Forms

Energy Modeling Guide & Template

GSG Reference Materials

NYC Sustainability Laws

Green Schools Guide Construction Toolkits

IDP Toolkit

Geothermal Feasibility Guide

Climate Resiliency Design Guide

Green Infrastructure Feasibility Guide

Renewable Energy Feasibility

Net Zero Energy Building Feasibility

Onsite Energy Generating Building Feasibility

GSG Sample Submissions

GSG Presentation

GREEN SCHOOLS GUIDE WEBSITE

GSG Sample Submissions

The following are examples for each design submission phase of a submission that is fairly complete and uses the appropriate Green Schools Guide forms.

The content of all the samples may or may not have been accepted by the GSG Committee reviewing the submission, but is intended to provide guidance as to a format that will expedite the review process and reduce the need for multiple resubmissions. Each phase submission is to be resubmitted separately until it is deemed complete. Click on the link for the appropriate sample submission for the appropriate Rating System.

To view the Green Schools Rating Sample Submissions, you must have Adobe Acrobat Reader installed on your computer. If you do not have Adobe Acrobat Reader installed, follow the link below to install the latest version of [Adobe Acrobat Reader](#) Please note that provided sample submissions serve only as references and are project-specific.

2019 Rating System Sample Submission

- [IDP](#)
- [Schematic](#)

2016 Rating System Sample Submission

- [Schematic](#)
- [Design Development](#)
- [60% Construction Documents](#)
- [100% Construction Documents](#)
- [Design Certification](#)
- [Construction Phase](#)

2009 Rating System Sample Submission

- [Schematic](#)
- [Design Development](#)
- [60% Construction Documents](#)
- [Construction Phase](#)

GSG Presentation

SD TIMELINE

SUBMITTAL TIMELINE

Schematic Design (SD) GSG Submittal, concurrent with the SD submission

| | Phase ID/Activity ID | Name | Start Date | End Date |
|--|----------------------|------------------------------------|---------------|---------------|
| | SC210-30 | Pre-Schematic Review & Approval | 4/29/2020 [A] | 5/8/2020 [A] |
| | SC230-10 | Schematic Report | 4/29/2020 [A] | 6/9/2020 [A] |
| | SC230-12 | Schematic Variation 1 | 4/29/2020 [A] | 6/9/2020 [A] |
| | SC230-14 | Schematic Variation 2 | 4/29/2020 [A] | 6/9/2020 [A] |
| | SC230-16 | Schematic Variation 3 | 4/29/2020 [A] | 6/9/2020 [A] |
| | SC230-20 | Schematic Cost Estimate | 6/10/2020 [A] | 6/10/2020 [A] |
| | SC230-30 | Schematic Design Review & Approval | 6/10/2020 [A] | 6/23/2020 [A] |
| | SC240-05 | Request and Receive CP | 1/30/2021 [A] | 2/3/2021 [A] |
| | SC240-10 | Design Development Documents | 6/10/2020 [A] | 8/11/2020 [A] |

DOCUMENTATION REQUIREMENTS

SD SUBMITTALS

Documentation

Include **revised IDP Workshop Report** in the submission

Submit initial **Project Checklist**

Submit **Program of Requirements (POR)**

Project Info Overview worksheet and **Project Info Directory Design** worksheet

Submit a **Credit Compliance Narrative** for each of the **Location, Site, Energy, Indoor Environmental Quality and Innovation** credits where applicable and required.

Include an **explanation** of each credit that is determined to be **not feasible**.

Each **narrative** should describe:

- 1) the approach to pursuing the credit
- 2) compliance methodology
- 3) SCA **specification sections** and **standard details** that will be included in the construction documents to achieve compliance.

Submit **supporting documentation** where required.

- If supporting documentation includes a drawing, then the **referenced drawing** will need to be included in the appendix of the electronic submission.

SD Credit Forms where applicable

IDP WORKSHOP REPORT

IDP Workshop Report Contents

All (6) **discovery analysis** completed, including credit impacts of strategies evaluated.

Update discovery analysis where applicable as per workshop meeting minutes (action items and recommendations).

Energy and Daylight Related Systems

Water-Related Systems/Green Infrastructure

Preliminary Life-Cycle Impacts Assessment (LCA)

Active Design

Acoustics

Climate Resiliency

Meeting minutes from workshop

Results and design impacts after workshop, including how the **IDP discovery analysis** informed the building design

Submit completed Integrative Design Process **Credit Form**

GSG CREDIT FORMS

Schematic Design Credit Forms

P1.1R- Integrative Design Process Credit Form

L1.3 Surrounding Density Credit Form

L1.4R Diverse Uses Credit Form

S1.2R Enhanced Site Assessment Credit Form

S2.4 Rainwater Management Credit Form

GSG Forms have been updated as of March 2021

GSG REPORTING TEMPLATES

Schematic Design Reporting Templates

Onsite Energy Generating Building Feasibility/ Net Zero Energy Building Feasibility

NYC Green Schools Guide

You are here: Design > NYC Green Schools Guide

Architecture & Engineering

Bulletins

Design Standards

DIIT Standards

Downloads

Forms

General Policies

Historic Schools Rehabilitation Guide

Manuals: CADD, BIM, CIP

MS4 Pollution Prevention

NYC Green Schools Guide

Procedural Guidelines

Reference Materials

Scoping Guidelines

Submission for Payment

Universal Pre-K (UPK) and 3-K

Overview

GSG Forms

Energy Modeling Guide & Template

GSG Reference Materials

NYC Sustainability Laws

Green Schools Guide Construction Toolkits

IDP Toolkit

Geothermal Feasibility Guide

Climate Resiliency Design Guide

Green Infrastructure Feasibility Guide

Renewable Energy Feasibility

[Net Zero Energy Building Feasibility](#)

[Onsite Energy Generating Building Feasibility](#)

GSG Sample Submissions

GSG Presentation

CREDIT REVIEW

FREQUENTLY ASKED QUESTIONS + UPDATES

L2.2 – Bicycle Facilities

Credit Clarification

New addition projects: if the area of the addition is greater than 50% of the area of the existing building, the population of the existing building shall be included in the calculation of the exterior bicycle storage racks.

Covered and uncovered bike storage:

- For compliance with GSG 2019, exterior bicycle storage racks for new buildings, annex and additions should be covered.

- Exterior bicycle storage racks for existing buildings do not need to be covered.

For compliance with GSG 2019, regardless of calculations for new buildings, annex and additions, a minimum of **5** exterior covered bicycle storage racks should be provided.

Even if the credit is not feasible by providing the required minimum number of bicycle storage racks, the design team is to provide **as many bike storage racks as is possible**.

S3.1R – Joint Use of Facilities

Credit Clarification/Update

Design appropriate entrances for community use of school facilities **for a minimum of 3 spaces**

Playing fields has been added as an acceptable space

Auditorium

Library

Gymnasium

Classrooms

Cafeteria

Playing Fields

S2.2 – Open Space

Credit Clarification

The GSG project boundary must include all scope of work associated with the project, including sidewalk work limited to the curb line.

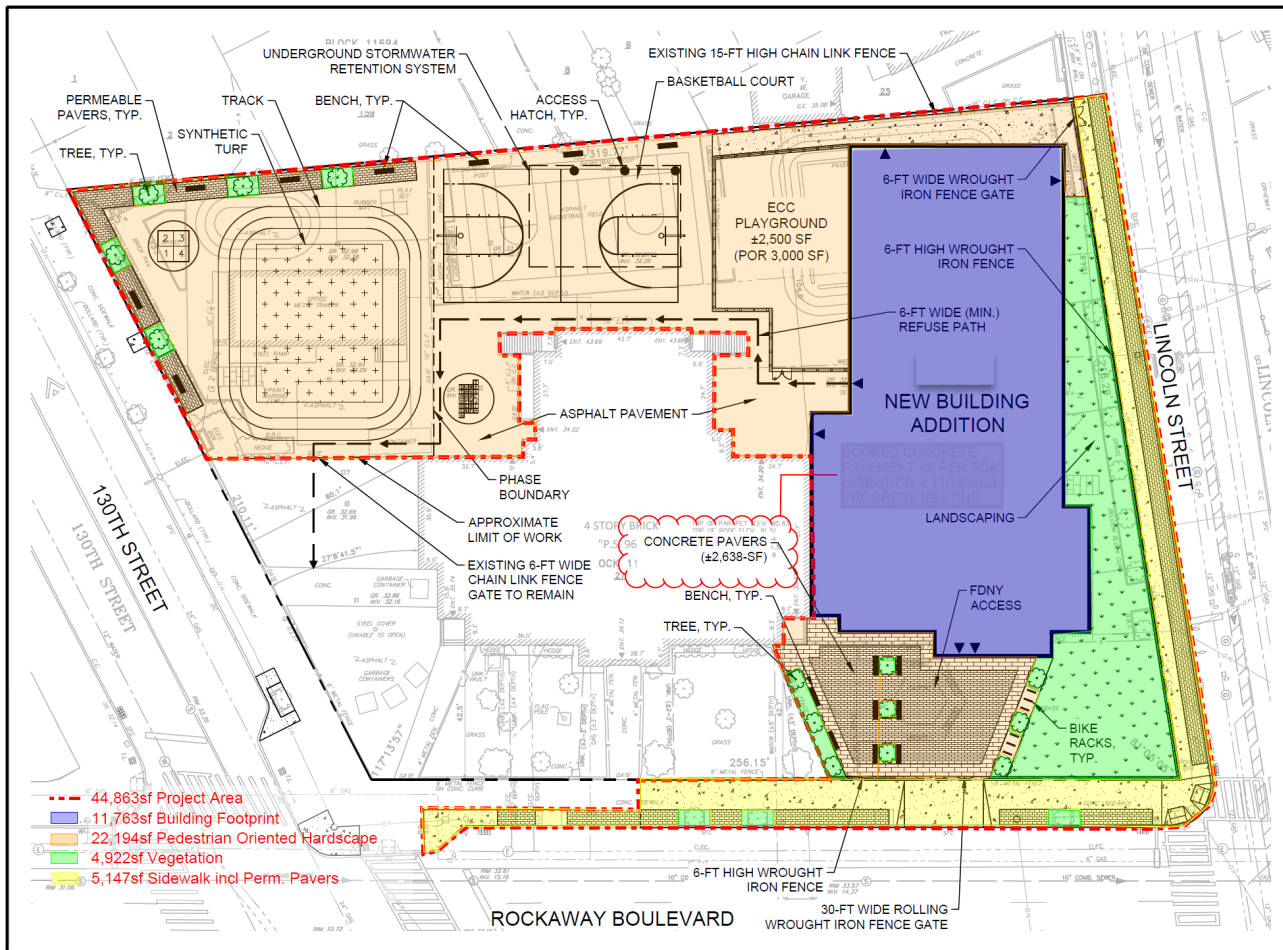

E6.1P- Feasibility of Renewable Energy

| Credit Clarification | Stories Threshold | Feasibility Analysis |
|-----------------------------------|-------------------|---|
| Net Zero Energy Building | 3 stories or less | Produce energy onsite from renewable energy sources in an amount equal to or greater than such building's total energy needs |
| Onsite Energy Generating Building | > 3 stories | Produce energy onsite from renewable energy sources in an amount equal to or greater than 10% of such building's total energy needs. |

This feasibility is required for Local Law 31/2016 compliance

Renewable Energy Feasibility



Net Zero Energy Building Feasibility

Onsite Energy Generating Building Feasibility

Q1.1P – Minimum IAQ Performance

Credit Clarification

- Outdoor Air Assessment is performed by the internal SCA IEH group
***DPM should follow up on its status**
- SCA will request **CFD** (computational fluid dynamics) **modeling** to understand how pollutants will affect health of building occupancy. In some cases, it will require modification to HVAC system (ex: special filters, mapping out air intake locations)
- CFD modeling is a complicated/lengthy process, so it is important to submit the **Outdoor Air Assessment Report** in a timely manner with the SD submission.

I1.1R – LEED Accredited Professional

Credit Clarification

Must have LEED AP specialty- LEED AP BD+C.

Must be an active project team member and without expired credential.

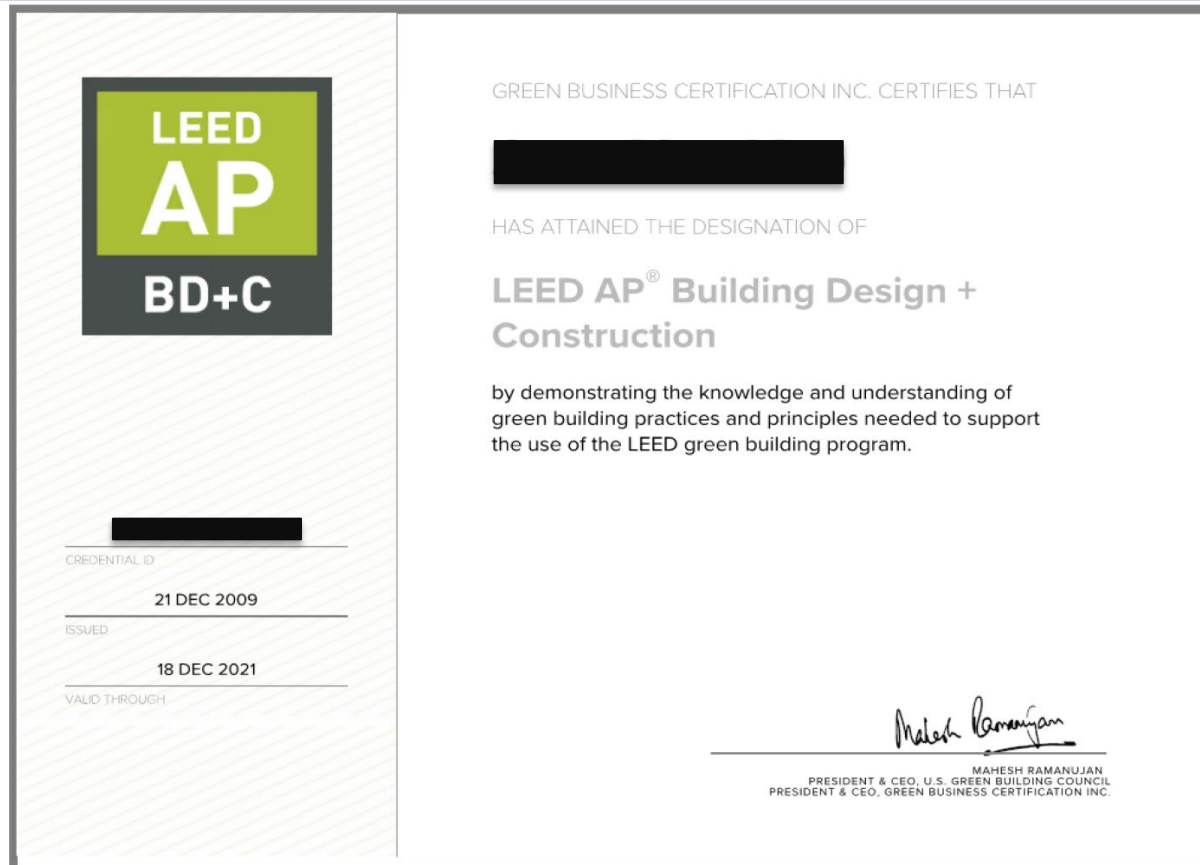



**All SD Submissions shall be emailed
to NYCGSG-Submissions@nycsca.org**

NEW YORK CITY
GREEN SCHOOLS GUIDE
2019